



# BEAUTIFIL Injectable

## EN Instructions for use

04:2019-03  
71505

**Manufacturer**  
SHOFU INC.  
11 Kamitakamatsu-cho, Fukuine,  
Higashiyama-ku, Kyoto 605-0983, Japan  
www.shofu.com

**EC REP**  
SHOFU DENTAL GmbH  
Am Brüll 17, 40878 Ratingen,  
Germany

SHOFU DENTAL ASIA-PACIFIC PTE.LTD.  
10 Science Park Road, #03-12,  
The Alpha, Science Park II, Singapore 117684



EN

READ CAREFULLY BEFORE USE

## Fluoride Releasing Restorative Material

BEAUTIFIL Injectable is a light-cured radiopaque restorative material indicated for anterior and posterior restorations.

### SHADES

A1, A2, A3, A3.5, A4, B1, B2, C2, A10, A20  
SA0.5, SA0.5O, Inc, BW

### COMPOSITION

Bis-GMA, TEGDMA, S-PRG filler based on fluoroboroaluminosilicate glass, Polymerization initiator, Pigments and others

### INDICATIONS

- Anterior and posterior restorations
- Repair of restorations and prostheses

### PRECAUTIONS

1. Do not use this product on patients with known allergies to this material and/or methacrylate monomer.
2. Operators with known allergies to this material and/or methacrylate monomer must not use this product.
3. If any inflammation or other allergic reactions occur on either the patient or operator, immediately discontinue use and seek medical advice.
4. Use medical (dental) gloves and protective glasses to avoid sensitization to this product. In case of accidental contact with oral soft tissue or skin, immediately blot with alcohol moistened cotton ball, and rinse with plenty of water. Medical (dental) gloves provide some protection against direct contact with this material; however some monomers can penetrate through the gloves very quickly to reach the skin. Therefore, should this material contact even the gloves, immediately remove them and wash hands with plenty of water. In case of contact with eyes, immediately flush the eyes with plenty of water and seek medical advice.
5. This product is intended for use by dental professionals only.

### DIRECTIONS FOR USE

#### A. Anterior and posterior restorations

- A-1. Cleaning of tooth surface  
Thoroughly clean the tooth surface to remove plaque.
- A-2. Shade selection  
Select appropriate shade using a shade guide while the tooth is still moist.
- A-3. Cavity preparation  
Prepare the cavity following the conventional method.
- A-4. Isolation  
Isolate with a rubber dam.
- A-5. Pulp protection  
In the case where the pulp is exposed or the affected area is close to the pulp, cap the pulp with calcium hydroxide etc.

- Do not use eugenol containing materials since they might inhibit polymerization or adhesion of the material.

A-6. Conditioning and application of adhesive  
Apply dentin adhesive following the manufacturer's instructions for use.

#### A-7. Delivery

Follow the instructions below to attach the BEAUTIFIL Needle Tip provided.

- 1) Pull off the shield cap while turning it slowly (Fig.A).
  - 2) Attach the needle tip by turning it clockwise until it is securely attached (Fig.B).
- Wear clean medical (dental) gloves when replacing the needle tip.

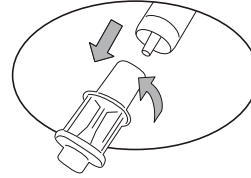

Fig. A

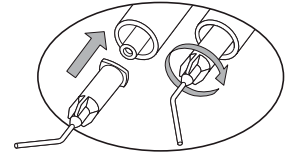

Fig. B

#### A-8. Placement

Apply necessary amount of BEAUTIFIL Injectable directly into the cavity and create the shape desired. BEAUTIFIL Injectable may also be extruded onto a paper pad etc to be applied into the cavity with a suitable instrument.

- When storing these materials in a refrigerator, allow them to reach room temperature before use.
- The paste dispensed onto the paper pad should be shielded from ambient light by light-shielding cover to avoid unintended polymerization of the material.
- Needle tips should be used for only one patient and then discarded at the end of the procedure to avoid cross contamination.

#### A-9. Light-curing

Light-cure using a dental light-curing unit.

- When the cavity is deep, incremental filling and light-curing not exceeding 2 mm is recommended.
- When the cavity surface is large, light-cure in segments.
- Dental light-curing unit and light-curing time

Light-curing unit	Halogen	LED
Light-curing time	20 sec.	10 sec.

- Halogen light-curing unit  
Wavelength: 400-500 nm, Light intensity:  $\geq 500$  mW/cm<sup>2</sup>
- LED light-curing unit  
Wavelength: 440-490 nm, Light intensity:  $\geq 1000$  mW/cm<sup>2</sup>
- Use a dental light-curing unit having specifications equivalent to those described above. When using the one having performance other than these recommendations, follow the instructions of each unit to light-cure BEAUTIFIL Injectable properly.
- Operators must use protective glasses or light shielding plate to avoid looking directly at the curing light. Operators must also protect patients' eyes from direct exposure to curing light.
- Disinfect the syringe and shield cap with alcohol after each use to avoid cross-contamination. Then, close the cap securely. Use caution to avoid including alcohol into the paste.
- Disinfect the light-curing unit with alcohol after each use to avoid cross-contamination.

#### A-10. Finishing and polishing

After light-curing, contour, finish and polish the restoration following the conventional method.

### B. Repair of restorations and prostheses

#### B-1. Clean the restoration

Thoroughly clean the restoration to remove plaque.

#### B-2. Shade selection

Select appropriate shade using a shade guide.

#### B-3. Isolation

Isolate with a rubber dam.

#### B-4. Pretreatment of the material to be bonded

Perform appropriate pretreatment for each material to be bonded (composite resin, porcelain, metal or natural tooth).

➤ Follow the instructions of each pretreatment material.

#### B-5. Delivery

Follow the procedures mentioned under "A-7. Delivery" to attach the BEAUTIFIL Needle Tip provided.

#### B-6. Placement

Apply necessary amount of BEAUTIFIL Injectable directly to the restoration and create the shape desired. BEAUTIFIL Injectable may also be extruded onto a paper pad to be applied to the restoration with a suitable instrument.

➤ Follow the procedures mentioned under "A-8. Placement".

#### B-7. Light-curing

Follow the procedures mentioned under "A-9. Light-curing" to light-cure the material.

#### B-8. Finishing and polishing

After light-curing, contour, finish and polish the restoration following the conventional method.

### **NOTE ON USE**

1. Follow the instructions for use of each dental material or instrument to be used in conjunction with this product.
2. Do not use this product for any purposes other than specifically outlined in the INDICATIONS in these instructions for use.
3. Use this product within the expiration date indicated on the package and container.  
(Example ☐ YYYY-MM-DD → Year-Month-Date of the expiration date)

### **STORAGE**

1. Store at room temperature (1-30 °C/34-86 °F). Avoid high temperatures and high humidity. Keep away from direct sunlight and any source of ignition.
2. Store this product in either way of the following.
  - 1) Discard the used needle tip and attach new one.  
Insert the needle into the small hole on the head of the shield cap (Fig.C).
  - 2) Discard the used needle tip and replace the shield cap securely (Fig.D).

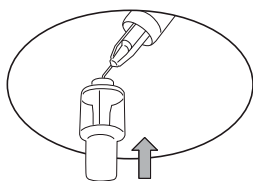

Fig. C

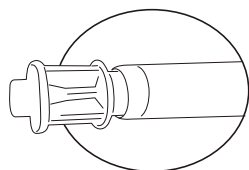

Fig. D